



51/427-441 Victoria Avenue Chatswood NSW

1  1 

Retail/Shops/Service Stations, Medical/Consulting Rooms, Showrooms/Bulky Goods for rent

Spacious Retail - Prime, cozy Location
Positioned on the top floor of Lemon Grove Shopping Centre, is this large, open plan shop with fantastic window display. Suitable for various uses (STCA).

- * Suitable for various uses (STCA)
- * Double shop frontage
- * Open plan - 145 sqm (approx)
- * Own Kitchenette
- * Attractive terms

Price : Retail Shop-Contact Agent
Building Size : 145 sqm
View : <https://www.property-square.com.au/lease/nsw/north-shore-lower/chatswood/residential/apartment/5882372>



Susan Chiu
02 9113 0888

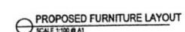

THE BUILDING WORKS ARE TO COMPLY WITH BCA SPECIFICALLY THE FOLLOWING CLAUSES:

- * SPEC C1.1 - FIRE RESISTING CONSTRUCTION
- * SPEC C1.10 - FIRE HAZARD PROPERTIES
- * CLAUSE C3.15 - OPENINGS FOR SERVICE INST
- * CLAUSE D1.10 - DISCHARGE FROM EXITS
- * CLAUSE D2.7 - INSTALLATIONS IN EXITS AND TRAVEL
- * CLAUSE D3.2 - GENERAL BUILDING ACCESS REQUIREMENTS

- REMOVAL OF EXISTING MIRRORS;
- REMOVAL OF SOME POWER POINTS, WHILE THE LINES WILL BE RETAINED;
- REMOVE EXISTING FURNITURES;
- REMOVE EXISTING SHAMPOO CHAIRS & RETAIN EXISTING HOT AND COLD WATER POINTS;
- REMOVE EXISTING BASIN FOR SHAMPOO CHAIRS;
- RETAIN ALL STRUCTURAL ELEMENTS;
- REMOVE AND REPLACE CEILING PANELS;
- INSTALL NEW TIMBER FLOORING;
- INSTALL NEW SHELVES AND FURNITURE.

REV.	DESCRIPTION	DRAWN	DATE	ADDRESS	PROJECT	JOB NUMBER	SCALES	SHEET NO.
				SHOP 8, 107-121 QUAY ST, HAYMARKET	SHOP FIT OUT	11.1038	1 : 100	DA 100
				CLIENT	DRAWING TITLE	DRAWN	DATE	REV
				ALEX YANG	PLANS & SECTION	E.WU	01-04-11	-

Dstudio
Architects Pty Limited

THIS DESIGN IS COPYRIGHT © 2004 BY THE ARCHITECT. ALL RIGHTS RESERVED. NO PART OF THIS DESIGN MAY BE REPRODUCED OR TRANSMITTED IN ANY FORM OR BY ANY MEANS, ELECTRONIC OR MECHANICAL, WITHOUT PERMISSION IN WRITING FROM THE ARCHITECT. ALL OTHER RIGHTS ARE RESERVED.